

4.3-10 jack (female) Connector 4 Panel Receptacle Mount
Stub Terminal, 19mm (.748 inch) Hole Spacing DC- 12 GHz VSWR1.20 (Low PIM)

43102GFA50-4380A / H4-LP

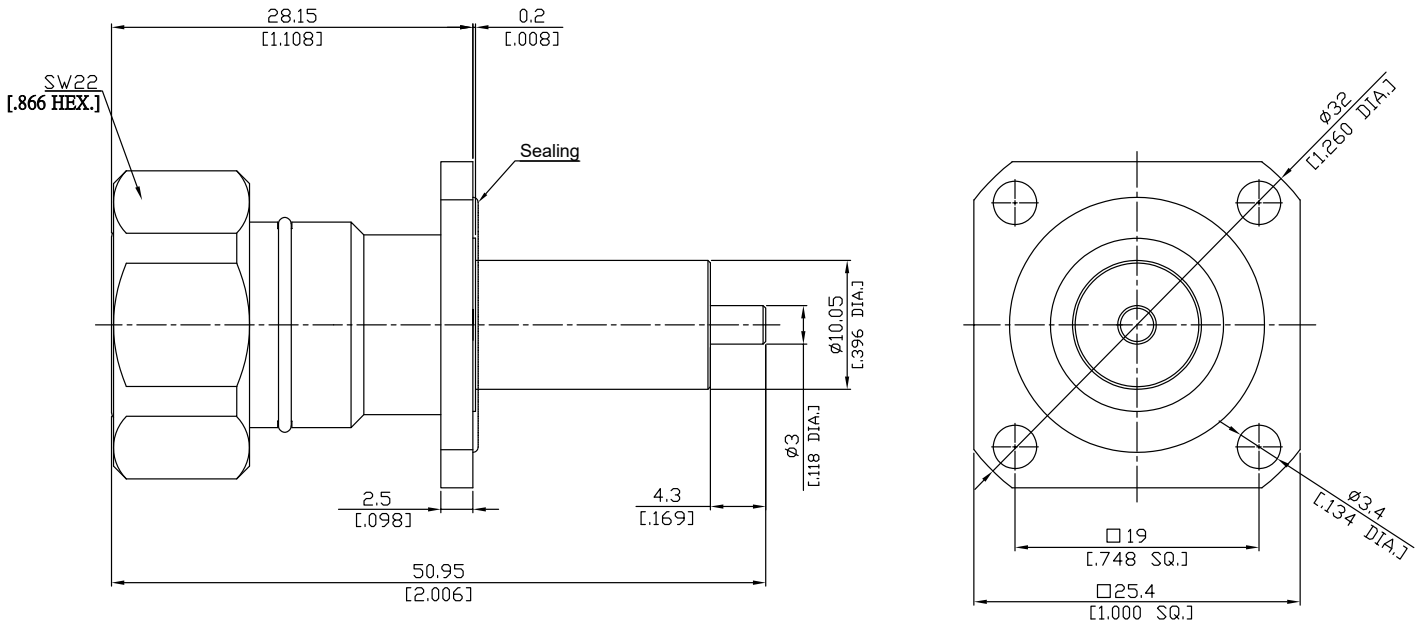

All dimensions are in mm [inch]
Tolerances according to DIN ISO 2768-mH

Interface

According to IEC 61169-54

Electrical Data

Impedance	50 Ω
Frequency	DC to 12 GHz
VSWR (Return Loss)	DC-6 GHz: ≤ 1.20 (≥ 20.83 dB)
Insertion Loss	DC-6 GHz: ≤ 0.1 × √F (GHz) dB
Insulation Resistance	≥ 5 GΩ
Center contact resistance	≤ 1.0 mΩ
Outer contact resistance	≤ 1.0 mΩ
Test voltage	2500 V rms
Working voltage	500 V rms
RF-leakage	≥ 110 dB @ DC to 6 GHz for tool tightened plugs ≥ 70 dB @ 3 to 6 GHz for tool-less plugs
Power handling	500 W @ 2.0 GHz
PIM level	0.4 - 4 GHz: ≥ 155 dBc

Electrical values valid for the interface only. Actual values will depend on application and manufacturing method.

Material And Plating

Piece Parts	Material	Plating
Centre contact	Phosphor Bronze	Gold plating, 3 μinch (Non-magnetic nickel-phosphorus underplating, 80 μinch)
Body	Brass	Copper-Tin-Zinc Alloy
Insulator	PTFE	
Gasket	Silicon Rubber	

4.3-10 jack (female) Connector 4 Panel Receptacle Mount
Stub Terminal, 19mm (.748 inch) Hole Spacing DC- 12 GHz VSWR1.20 (Low PIM)

43102GFA50-4380A / H4-LP

Mechanical Data

Coupling mechanisms	Screw-lock
Mating Cycles	≥ 500
Terminal Type	Stub
Captivated Type	Mechanical Captivation
Recommended torque	5 Nm

Environmental Data

Temperature Range	-65°C to +165°C
Thermal shock	IEC 61169-1 9.4.4
Corrosion	ISO 21207 method B
Vibration	IEC 61169-1 9.3.3 and IEC 60068-2-64
Shock	IEC 61169-1 9.3.14
Moisture Resistance	IEC 60529, IP68 1.5 h / 1 m
RoHS	compliant

Packing

Single or 100